

| BUILDING DESCRIPTION | |
|----------------------------|---------------------|
| VALUATION METHOD: | R - RESIDENTIAL |
| USE CODE: | D - DWELLING |
| STYLE: | C - CONVENTIONAL |
| FOUNDATION: | C - CONTINUOUS WALL |
| EXTERIOR WALL 1: | AV - ALUM/VINYL |
| EXTERIOR WALL 2: | |
| ROOF STRUCTURE: | G - GABLE |
| ROOF COVER: | M - METAL |
| BEDROOMS: | 3 |
| FULL BATHS: | 2 |
| HALF BATHS: | 1 |
| ADDITIONAL FIXTURES: | |
| FIREPLACE TYPE/CNT/OPN/CH: | |
| ELEVATOR TYPE/COUNT/STOPS: | |
| PHYS OVERRIDE: | |
| ECONOMIC DEPRECIATION: | |
| FUNCTIONAL DEPRECIATION: | |
| SPECIAL CONDITION CODE: | |
| SPECIAL CONDITION VALUE: | |
| DESCRIPTION: | 1.5/S FR DWLG & B |
| REMARKS: | |
| HEATED SQUARE FEET: | 2,361 |

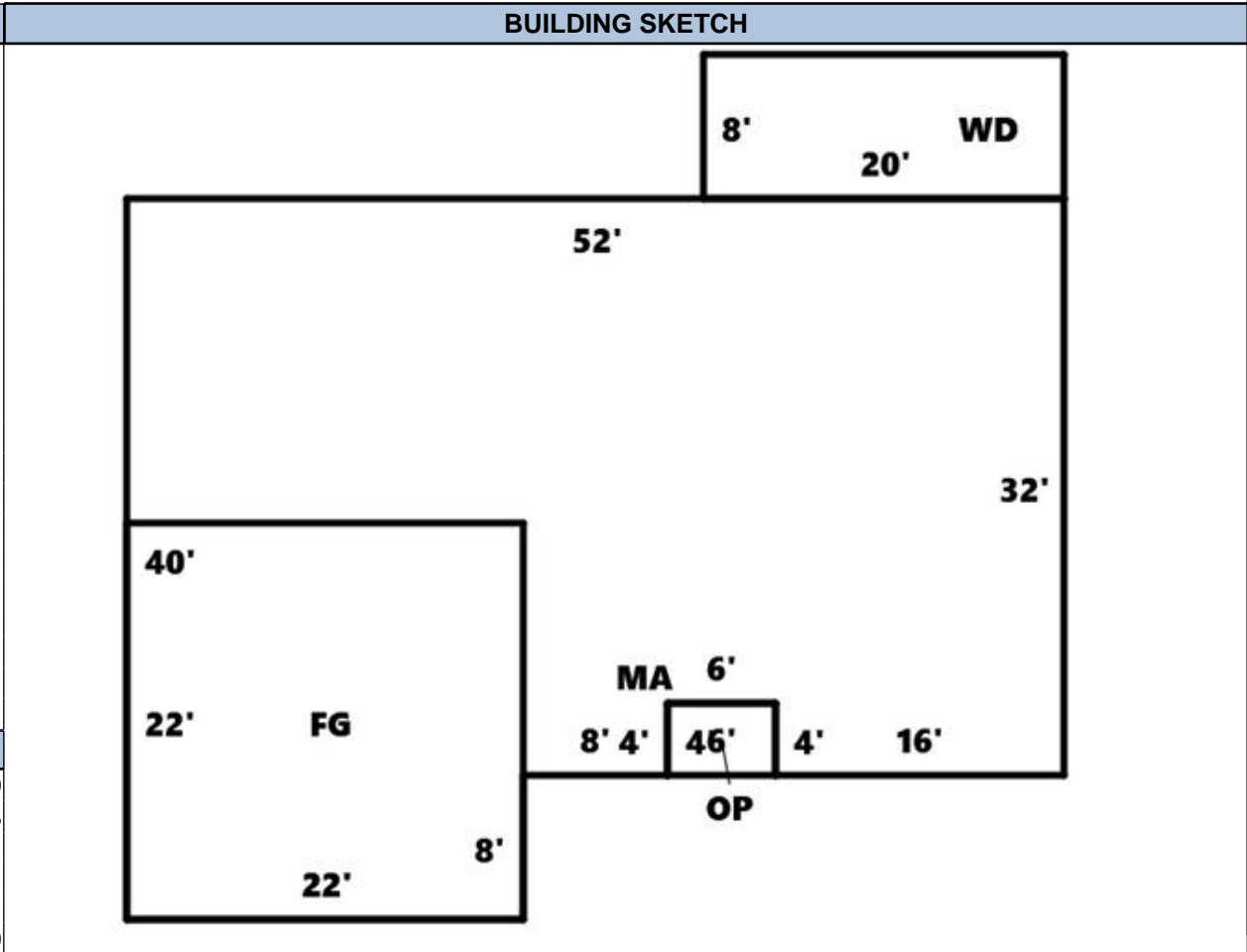

| BUILDING COMPUTATION | |
|--|---------|
| REPLACEMENT COST NEW | 537,090 |
| PHYSICAL DEPRECIATION | 23% |
| FUNCTIONAL DEPRECIATION | |
| ECONOMIC DEPRECIATION | |
| % COMPLETE | |
| REPLACEMENT COST NEW LESS DEPRECIATION | 413,590 |

| BUILDING SECTION DETAIL | | | | | | | | | | | | | | |
|-------------------------|------|-----|-----------|-------|------|------------|-------|------|------|------|-----|----|----|--------|
| TYPE | AREA | #ST | HEAT TYPE | HEAT% | AIR% | SPRINKLER% | GRADE | AYB | EYB | COND | P% | E% | F% | VALUE |
| MA | 1816 | 1.0 | P | | 100% | | B | 1993 | 1999 | A | 77% | | | 277490 |
| FG | 484 | 1.0 | | | | | | | | | 77% | | | 40800 |
| FUS | 545 | 1.0 | | | | | | | | | 77% | | | 70500 |
| LLU | 908 | 1.0 | | | | | | | | | 77% | | | 20400 |
| OP | 24 | 1.0 | | | | | | | | | 77% | | | 1000 |
| WD | 160 | 1.0 | | | | | | | | | 77% | | | 3400 |
| | | | | | | | | | | | | | | |
| | | | | | | | | | | | | | | |
| | | | | | | | | | | | | | | |
| | | | | | | | | | | | | | | |
| | | | | | | | | | | | | | | |