

JACOBSON, JASON
 JACOBSON, TINA
 1119 NATURES HAMMOCK RD N
 SAINT JOHNS, FL 32259-2891
 ACCOUNT NUMBER: 148919

Macon County, North Carolina

Parcel: 6505369879
 Tax Year: 2027
 Reval Year: 2023
 Appraised By: 25 on 05/03/2022
 Information Source: E - ESTIMATE

Tax Districts
 GENERAL COUNTY TAX, LANDFILL FEE RESIDENTIAL (1), NANTAHALA FIRE
 DISTRICT TAX

PARCEL INFORMATION		PROPERTY DESCRIPTION				SALES INFORMATION				
Address:	362 NANTAHALA HARBOR DR	LOT 14 REV NANTAHALA HARBOR				Date	Sales Price	Valid	Book / Page	
Neighborhood:	09019 - NANTAHALA HARBOR SUBD	1.6200 AC				2/15/2021	380000	Y	Q-40/634	
		PERMIT INFORMATION								
Road Type:	T - PRIVATE DIRT	Code	Date	Permit #	Amount	9/10/2007	140000	N	R-31/1516	
Township:	09 - NANTAHALA					Plat Book:		5	Plat Card:	11344
Utilities:	S-1, CW-1									
View:	LV - LAKE VIEW									

NOTES	VALUE SUMMARY
LISTED FOR 676,000 4/26	LAND: 117,600 BUILDING: 413,100 OBXF: 0 TOTAL APPRAISED: 530,700 DEFERRED VALUE: 0 NET TAXABLE: 530,700

LAND DATA - MARKET VALUE															
	MTH	CODE	DESCRIPTION	ZONING	TOPO 1	TOPO 2	PRICE PER ACRE	ACRES	ADJ 1	ADJ 2	ADJ 3	UTILITIES	VALUE	NOTES	
1	A	0150	RES VIEW		T		72,593	1.620	S-25			4,000	117,600		
								Total Acres:	1.620				Total Land Value:	117,600	

OUTBUILDING DATA																	
CODE	DESC	GRADE	COUNT	LENGTH	WIDTH	UNITS	UNIT PRICE	STORIES	AYB	EYB	COND	PHYS	FOBS	EOBS	% CMPLT	TAX VALUE	NOTES

BUILDING DESCRIPTION

VALUATION METHOD: R - RESIDENTIAL
 USE CODE: D - DWELLING
 STYLE: PB - POST & BEAM
 FOUNDATION: C - CONTINUOUS WALL
 EXTERIOR WALL 1: F - FRAME
 EXTERIOR WALL 2:
 ROOF STRUCTURE: G - GABLE
 ROOF COVER: A - ASPH SHINGLE
 BEDROOMS: 3
 FULL BATHS: 3
 HALF BATHS:
 ADDITIONAL FIXTURES:
 FIREPLACE TYPE/CNT/OPN/CH: SS/1/1/1
 ELEVATOR TYPE/COUNT/STOPS:
 PHYS OVERRIDE:
 ECONOMIC DEPRECIATION:
 FUNCTIONAL DEPRECIATION:
 SPECIAL CONDITION CODE:
 SPECIAL CONDITION VALUE:
 DESCRIPTION: 1/S FR DWLG & B
 REMARKS:
 HEATED SQUARE FEET: 1,390

BUILDING SKETCH

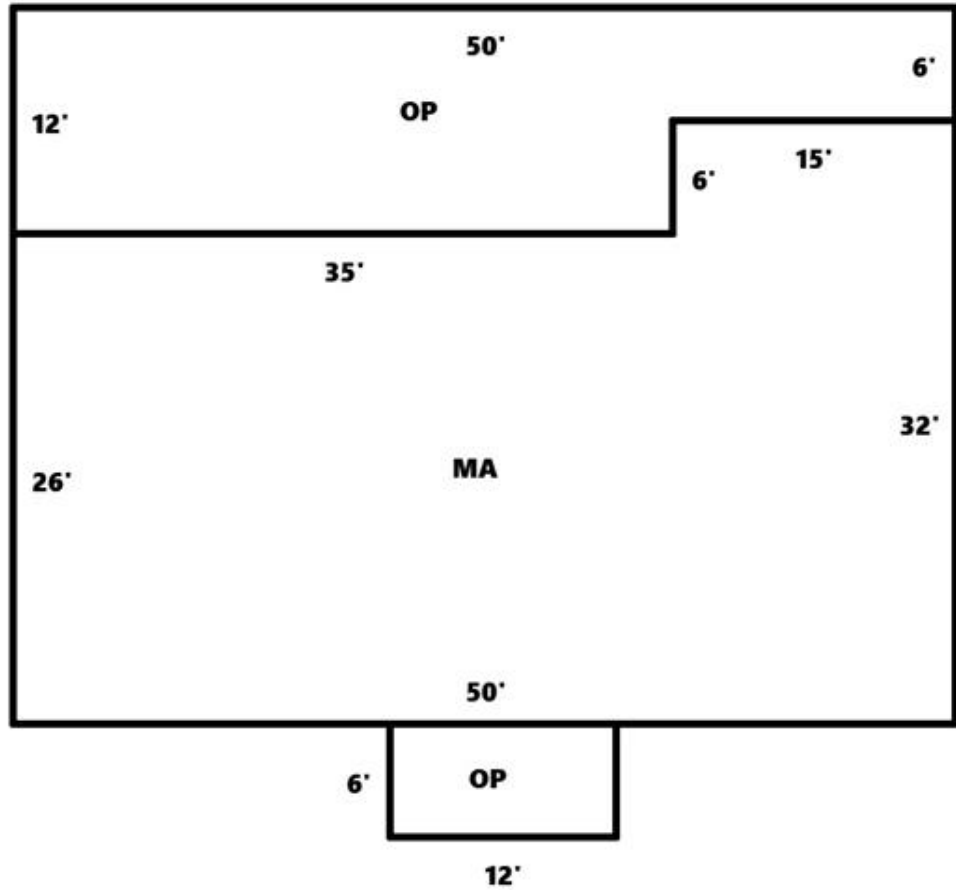

BUILDING COMPUTATION

REPLACEMENT COST NEW	459,140
PHYSICAL DEPRECIATION	10%
FUNCTIONAL DEPRECIATION	
ECONOMIC DEPRECIATION	
% COMPLETE	
REPLACEMENT COST NEW LESS DEPRECIATION	413,100

BUILDING SECTION DETAIL

TYPE	AREA	#ST	HEAT TYPE	HEAT%	AIR%	SPRINKLER%	GRADE	AYB	EYB	COND	P%	E%	F%	VALUE
MA	1390	1.0	P		100%		C+10	2011	2011	A	90%			253000
LLF	973	1.0									90%			85000
LLF	417	1.0									90%			36400
OP	72	1.0									90%			3300
OP	510	1.0									90%			23600
WD	510	1.0									90%			11800